

# 2.1MM ( FT TYPE )

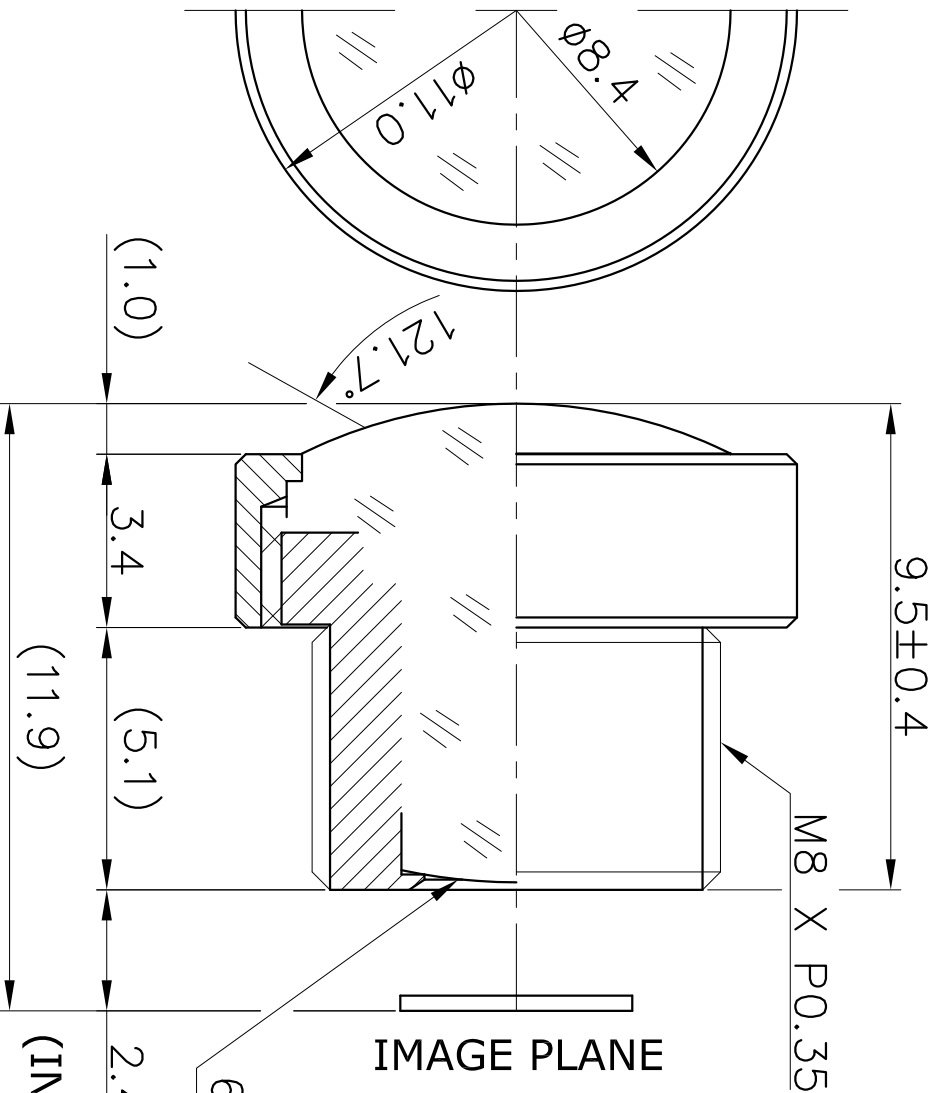

IMAGE PLANE

660nm IR-CUT Coating

$2.4 \pm 0.3$   
(IN AIR)

1. SENSING AREA : 1/4" CCD
  2. FOCAL LENGTH : 2.1MM ± 5%
  3. BACK FOCAL LENGTH : 2.5MM ± 5% (WITHOUT FILTER)
  4. MAXIMUM RELATIVE APERTURE : 2.5 ± 5%
  5. IRIS : FIXED
  6. LENS CONSTRUCTION : GELEMENTS (1ASP / 5G)
  7. ANGULAR FIELD OF VIEW :
    - DIAGONAL 121.7°
    - HORIZONTAL 97.4°
    - VERTICAL 73.2°
- ( IT IS CHANGEABLE ON EXTERNAL DIMENSION  
BY CUSTOMER'S REQUIREMENT. )

E-mail : hki9612@hkopto.com  
Website : http://www.hkopto.com

		TOLERANCES		Designed	BANG HYE SUN	Title	f=2.1MM Fno 2.5 1/4"CCD Automotive Lens
		ANGLE 1°/2	Checked	PARK JIN HYUN			
X.	± 0.2		Approved			DATE	2010.01.13
.X	± 0.1					REVISION NO.	-00
.XX	± 0.05						
A4	Scale	N/S		Dwg No.	HK-A216S(KTG M8)		