

2.1MM (FT TYPE)

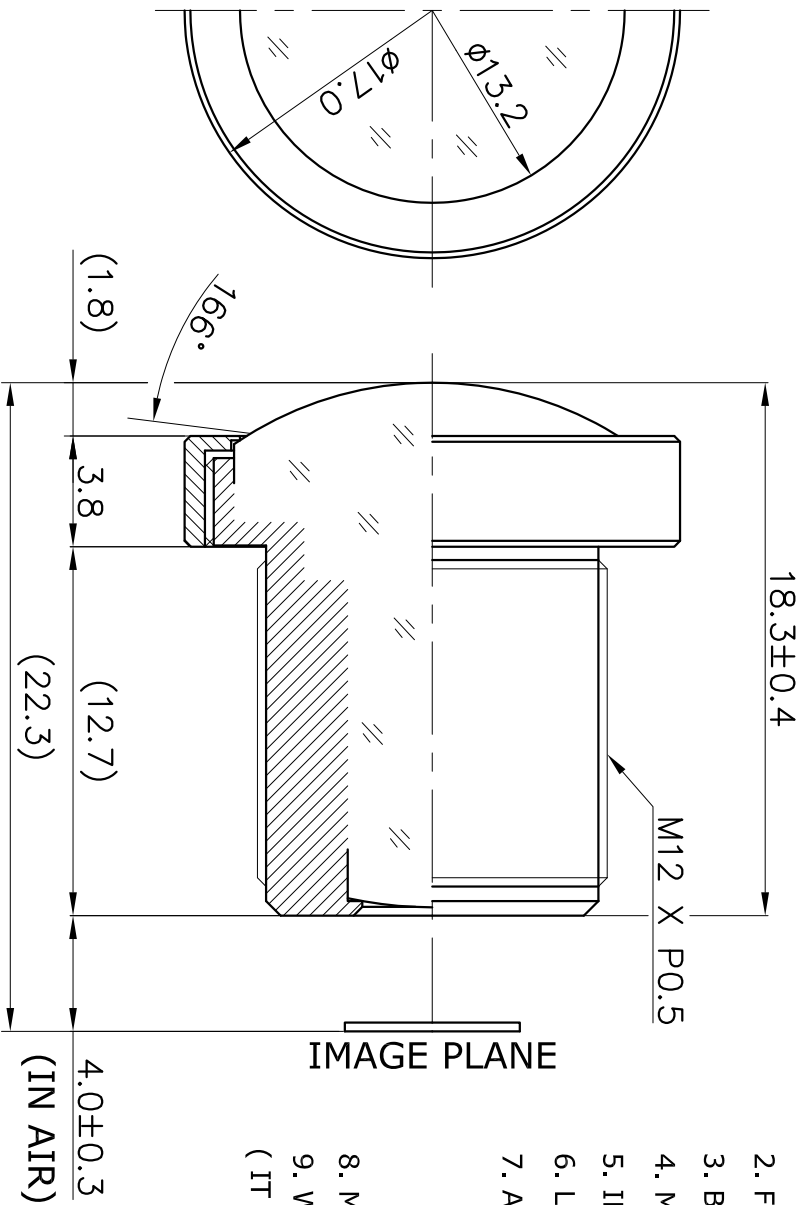

IMAGE PLANE

1. SENSING AREA : 1/3" CCD & (1/4"CCD)
 2. FOCAL LENGTH : 2.1MM ± 5%
 3. BACK FOCAL LENGTH : 4.25MM ± 5% (IN AIR)
 4. MAXIMUM RELATIVE APERTURE : 2.5 ± 5%
 5. IRIS : FIXED
 6. LENS CONSTRUCTION : 6COMPONENTS GELEMENTS
 7. ANGULAR FIELD OF VIEW : 1/3" & (1/4")
 DIAGONAL 165.7° & 121.6°
 HORIZONTAL 132.3° & 98.0°
 VERTICAL 102.0° & 74.1°
 8. MINIMUM OBJECT DISTANCE : 40CM -00
 9. WEIGHT : 6.1gr
- (IT IS CHANGEABLE ON EXTERNAL DIMENSION BY
 BY CUSTOMER'S REQUIREMENT.)

E-mail : hki9612@hkopto.com
 Website : http://www.hkopto.com

| | | | | | | | |
|-----|--------|------------|---------|---------------|--------------|-------|---|
| | | TOLERANCES | | Designed | BANG HYE SUN | Title | FOR B/W & COLOR f=2.1MM Fno 2.5 (HIGH RESOLUTION) |
| | | ANGLE 1°/2 | Checked | PARK JIN HYUN | | | |
| X. | ± 0.2 | .X | ± 0.1 | Approved | | DATE | 260807 |
| .XX | ± 0.05 | | | | | | REVISION NO. -00 |
| A4 | Scale | N/S | | Dwg No. | HK-R216S | | |