

# 16.0MM (K TYPE)

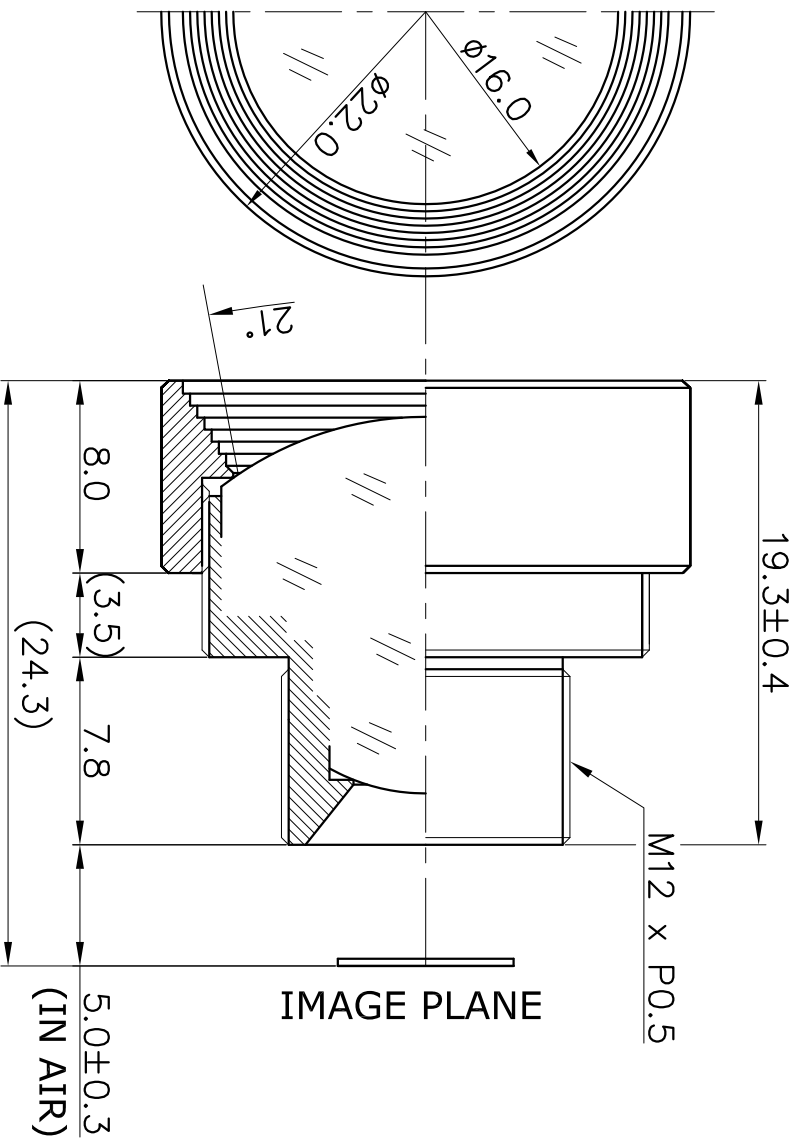

IMAGE PLANE

1. SENSING AREA : 1/2" CCD & (1/3"CCD)
  2. FOCAL LENGTH : 16.0MM ± 5%
  3. BACK FOCAL LENGTH : 7.20MM ± 5%
  4. MAXIMUM RELATIVE APERTURE : 1.2 ± 5%
  5. IRIS : WITHOUT DIAPHRAGM
  6. LENS CONSTRUCTION : 4COMPONENTS 4ELEMENTS
  7. ANGULAR FIELD OF VIEW : 1/2" & (1/3")  
 DIAGONAL 27.7° & 21.0°  
 HORIZONTAL 21.8° & 17.2°  
 VERTICAL 16.5° & 13.0°
  8. MINIMUM OBJECT DISTANCE : 30CM -00
  9. WEIGHT : 15.0 gr
- ( IT IS CHANGEABLE ON EXTERNAL DIMENSION BY  
 BY CUSTOMER'S REQUIREMENT.)

E-mail : hki9612@hkopto.com  
 Website : http://www.hkopto.com

		TOLERANCES		Designed	BANG HYE SUN	Title	FOR B/W & COLOR f=16.0MM Fno 1.2 ( HIGH RESOLUTION )
		ANGLE 1°/2	Checked	PARK JIN HYUN			
A4	Scale	N/S	X. ± 0.2	Approved	Dwg No.	DATE	250325
			.X ± 0.1				
			.XX ± 0.05				-00