

# 3.0MM (K TYPE)

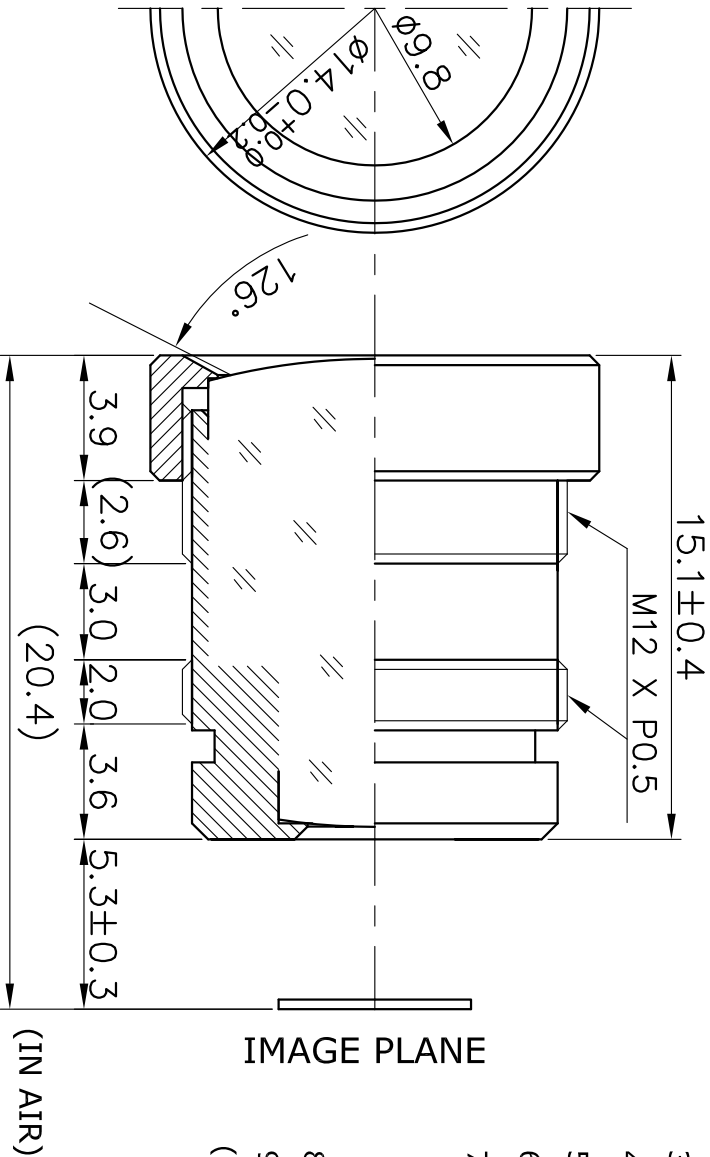

IMAGE PLANE

(IN AIR)

1. SENSING AREA : 1/3" CCD & (1/4" CCD)
  2. FOCAL LENGTH : 3.0MM ± 5%
  3. BACK FOCAL LENGTH : 5.67MM ± 5% (IN AIR)
  4. MAXIMUM RELATIVE APERTURE : 2.0± 5%
  5. IRIS : WITHOUT DIAPHRAGM
  6. LENS CONSTRUCTION : 4COMPONENTS 4ELEMENTS
  7. ANGULAR FIELD OF VIEW : 1/3" & (1/4")  
 DIAGONAL 126.0° & 88.2°  
 HORIZONTAL 94.4° & 69.9°  
 VERTICAL 69.5° & 51.7°
  8. MINIMUM OBJECT DISTANCE : 30CM -00
  9. WEIGHT : 5.9gr
- ( IT IS CHANGEABLE ON EXTERNAL DIMENSION  
 BY CUSTOMER'S REQUIREMENT.)



A4	Scale	N/S			Dwg No.	HK-R304S	DATE	2019.01.08	REVISION NO.
			TOLERANCES	Designed	BANG HYE SUN	Title		FOR B/W & COLOR	
			ANGLE 1°/2	Checked	PARK JIN HYUN			f=3.0MM Fno 2.0	
			X. ± 0.2	Approved				( HIGH RESOLUTION )	
			.X ± 0.1						
			.XX ± 0.05						

E-mail : hki9612@hkopto.com  
 Website : http://hkopto.com